

Seal for Construction  
 Revisions: No. Date Notes

**MDG**  
 MUOIO DESIGN GROUP, LLC

1075 S. State Avenue, Cary, NC 27513  
 919.286.8888, Fax: 919.286.8889

LANDSCAPE PLAN

Fairview Estates

AP-16, Lot R

1600 Fairview Avenue, Hopkinton Rhode Island

Job No: C-FairviewEstates  
 Dwg No: C-FairviewEstates\_L1.dwg  
 Drawn by: BMM  
 Checked by: BMM  
 Issue Date: 09-24-20

PERMITTING DOCUMENTS

THIS DRAWING IS THE PROPERTY OF THE ARCHITECT. ANY UNAUTHORIZED USE OF THIS DRAWING WITHOUT WRITTEN PERMISSION IS PROHIBITED.

Sheet 1 of 1

L-1

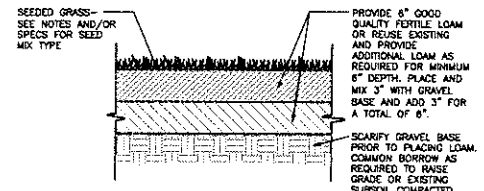
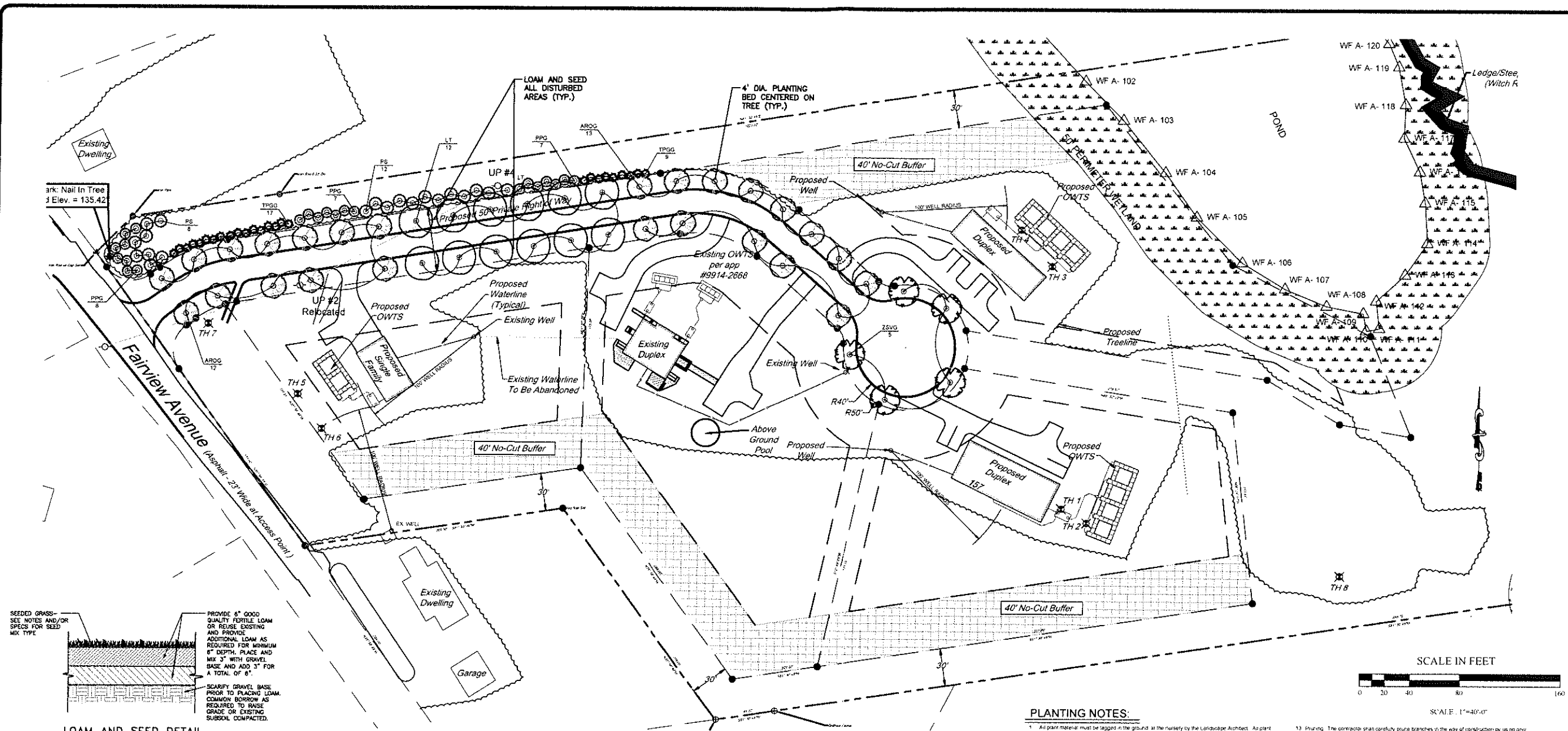

**PLANTING NOTES:**

- SEE SHEET L-2 FOR PLANTING DETAILS, NOTES, AND PLANTING SCHEDULE.
- ALL PLANTING BEDS SHALL BE MULCHED WITH 3\"/>

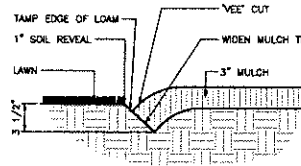

OVERALL PLANTING SCHEDULE																			
TREES, SHRUBS AND PERENNIALS																			
Key	Botanical Name (Common Name)	Qty	Size	Notes															
AROG	Arceuthobium (Turkey Oak)	25	2\"/>																
LT	Liriodendron tulipifera (Tulip Tree)	12	2\"/> <tr> <td>PPG</td> <td>Prunella virginiana (Blackberry)</td> <td>22</td> <td>5\"/&gt;  <tr> <td>PS</td> <td>Prunella serotina (Blackberry)</td> <td>20</td> <td>5\"/&gt;  <tr> <td>TPGG</td> <td>Thuja occidentalis (Green Tree)</td> <td>26</td> <td>5\"/&gt;  <tr> <td>ZSVG</td> <td>Zelkova serrata (Blue Spruce)</td> <td>5</td> <td>2\"/&gt;  </td></tr></td></tr></td></tr></td></tr>	PPG	Prunella virginiana (Blackberry)	22	5\"/> <tr> <td>PS</td> <td>Prunella serotina (Blackberry)</td> <td>20</td> <td>5\"/&gt;  <tr> <td>TPGG</td> <td>Thuja occidentalis (Green Tree)</td> <td>26</td> <td>5\"/&gt;  <tr> <td>ZSVG</td> <td>Zelkova serrata (Blue Spruce)</td> <td>5</td> <td>2\"/&gt;  </td></tr></td></tr></td></tr>	PS	Prunella serotina (Blackberry)	20	5\"/> <tr> <td>TPGG</td> <td>Thuja occidentalis (Green Tree)</td> <td>26</td> <td>5\"/&gt;  <tr> <td>ZSVG</td> <td>Zelkova serrata (Blue Spruce)</td> <td>5</td> <td>2\"/&gt;  </td></tr></td></tr>	TPGG	Thuja occidentalis (Green Tree)	26	5\"/> <tr> <td>ZSVG</td> <td>Zelkova serrata (Blue Spruce)</td> <td>5</td> <td>2\"/&gt;  </td></tr>	ZSVG	Zelkova serrata (Blue Spruce)	5	2\"/>
PPG	Prunella virginiana (Blackberry)	22	5\"/> <tr> <td>PS</td> <td>Prunella serotina (Blackberry)</td> <td>20</td> <td>5\"/&gt;  <tr> <td>TPGG</td> <td>Thuja occidentalis (Green Tree)</td> <td>26</td> <td>5\"/&gt;  <tr> <td>ZSVG</td> <td>Zelkova serrata (Blue Spruce)</td> <td>5</td> <td>2\"/&gt;  </td></tr></td></tr></td></tr>	PS	Prunella serotina (Blackberry)	20	5\"/> <tr> <td>TPGG</td> <td>Thuja occidentalis (Green Tree)</td> <td>26</td> <td>5\"/&gt;  <tr> <td>ZSVG</td> <td>Zelkova serrata (Blue Spruce)</td> <td>5</td> <td>2\"/&gt;  </td></tr></td></tr>	TPGG	Thuja occidentalis (Green Tree)	26	5\"/> <tr> <td>ZSVG</td> <td>Zelkova serrata (Blue Spruce)</td> <td>5</td> <td>2\"/&gt;  </td></tr>	ZSVG	Zelkova serrata (Blue Spruce)	5	2\"/>				
PS	Prunella serotina (Blackberry)	20	5\"/> <tr> <td>TPGG</td> <td>Thuja occidentalis (Green Tree)</td> <td>26</td> <td>5\"/&gt;  <tr> <td>ZSVG</td> <td>Zelkova serrata (Blue Spruce)</td> <td>5</td> <td>2\"/&gt;  </td></tr></td></tr>	TPGG	Thuja occidentalis (Green Tree)	26	5\"/> <tr> <td>ZSVG</td> <td>Zelkova serrata (Blue Spruce)</td> <td>5</td> <td>2\"/&gt;  </td></tr>	ZSVG	Zelkova serrata (Blue Spruce)	5	2\"/>								
TPGG	Thuja occidentalis (Green Tree)	26	5\"/> <tr> <td>ZSVG</td> <td>Zelkova serrata (Blue Spruce)</td> <td>5</td> <td>2\"/&gt;  </td></tr>	ZSVG	Zelkova serrata (Blue Spruce)	5	2\"/>												
ZSVG	Zelkova serrata (Blue Spruce)	5	2\"/>																

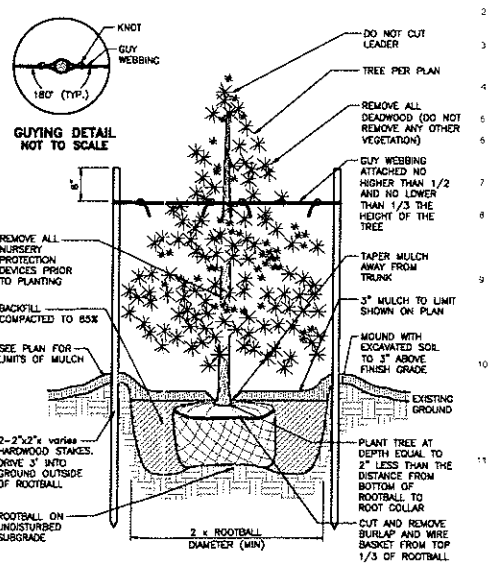
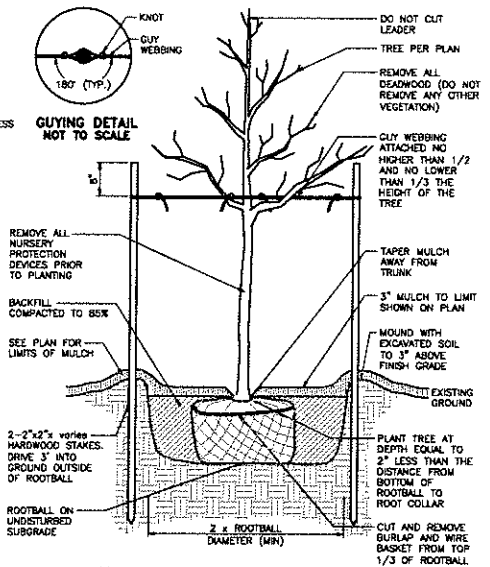

**PLANTING NOTES:**

- All plant material must be tagged in the nursery by the Landscape Architect. All plant material shall be commercially obtained and shall meet the American Association of Nurseryman standards for nursery stock. Label location and its amendments. Plant only during season normal to the particular variety. All plant inspections will be at the expense of the contractor. Permanent stakes will be required.
- Cover all planting beds with 3\"/>

